



## Proposed scheme to expand John Grant School

### Plans for a 5 Classroom new build extension

Dear Parents/Neighbours,

As part of Norfolk County Council's commitment to invest in Special Education Needs across the county we are proposing a new 5 classroom extension at John Grant School, which will provide an additional 30 pupil places. This increase is part of the Council's commitment to provide much needed SEND capacity across the county.

The proposal also includes additional shared teaching resource space and dedicated outside areas for 2 ASD classrooms.

A design team from NPS Property Consultants Ltd has been working closely with the school and the County Council on possible solutions and we anticipate submitting a planning application on the 14<sup>th</sup> July 2020, but before we do so we would like to share the proposal with parents and local residents.

Children's Services would usually hold an informal exhibition event, to display plans and discuss our proposals with local residents and interested parties, however due to the current COVID-19 pandemic and social distancing requirements this is currently not possible.

We would still like to share our plans with you and get any feedback, so the outline proposals are overleaf and we are inviting neighbouring residents to provide comment, either by letter or email to the address below. Note that these plans include expansion of the car park to allow for additional staff required to support the extra children and young people.

Once the planning application has been submitted there will be the opportunity for individuals and interested parties to express their views to the planning authority as a formal submission. If approved, it is hoped work will start in December 2020, and have an approximate 12 month build duration, and this will be reviewed in line with central government guidance on COVID-19 working procedures.

If you would like to discuss any of the above or have any queries regarding the proposals please contact Chris Brooker, Children's Services Project Officer by email [schoolreview@norfolk.gov.uk](mailto:schoolreview@norfolk.gov.uk)



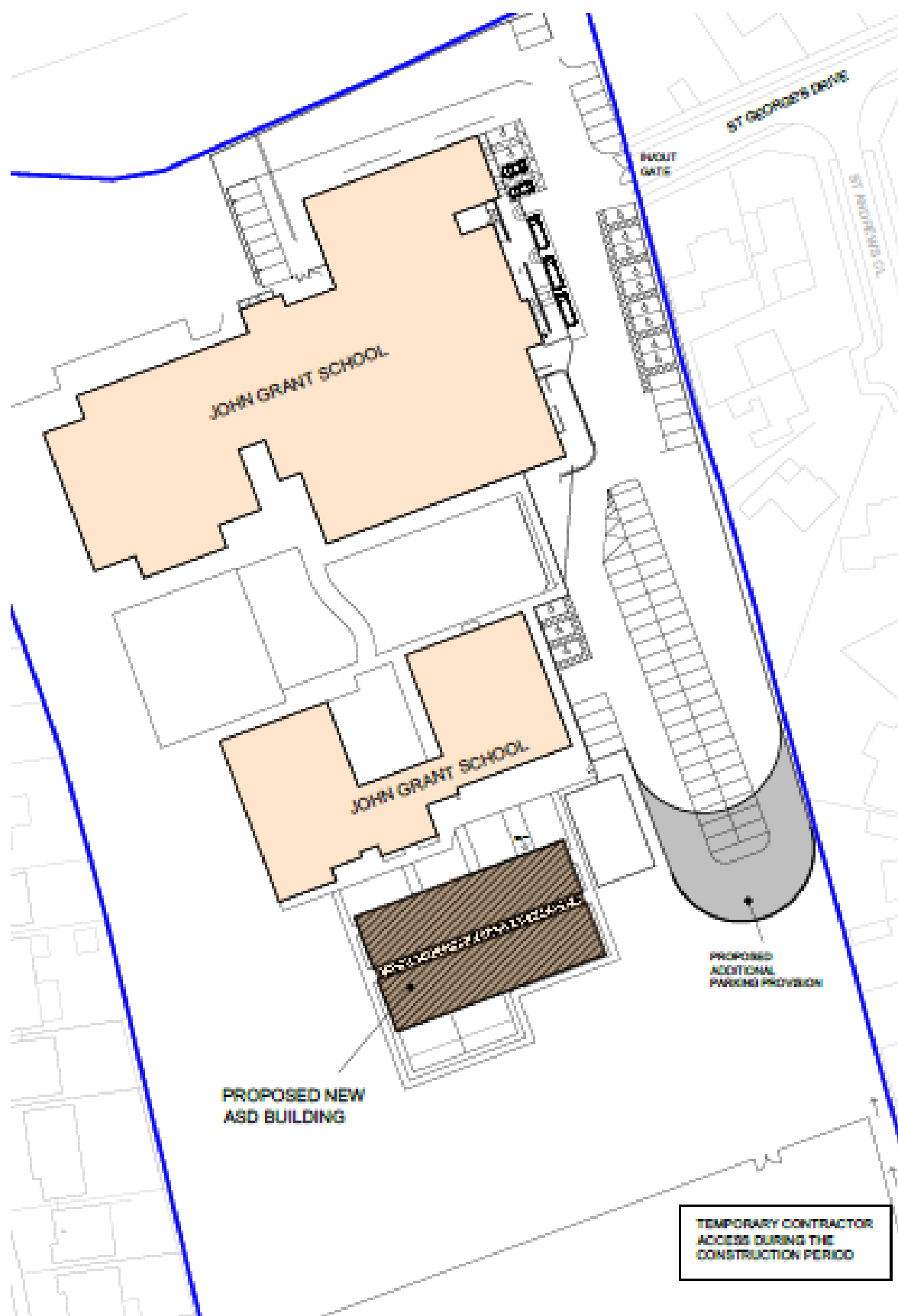

County Hall, Martineau Lane, Norwich, NR1 2DL  
[www.norfolk.gov.uk](http://www.norfolk.gov.uk) – [schoolreview@norfolk.gov.uk](mailto:schoolreview@norfolk.gov.uk)



INVESTOR IN PEOPLE